

Main Level Floor Plan

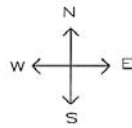
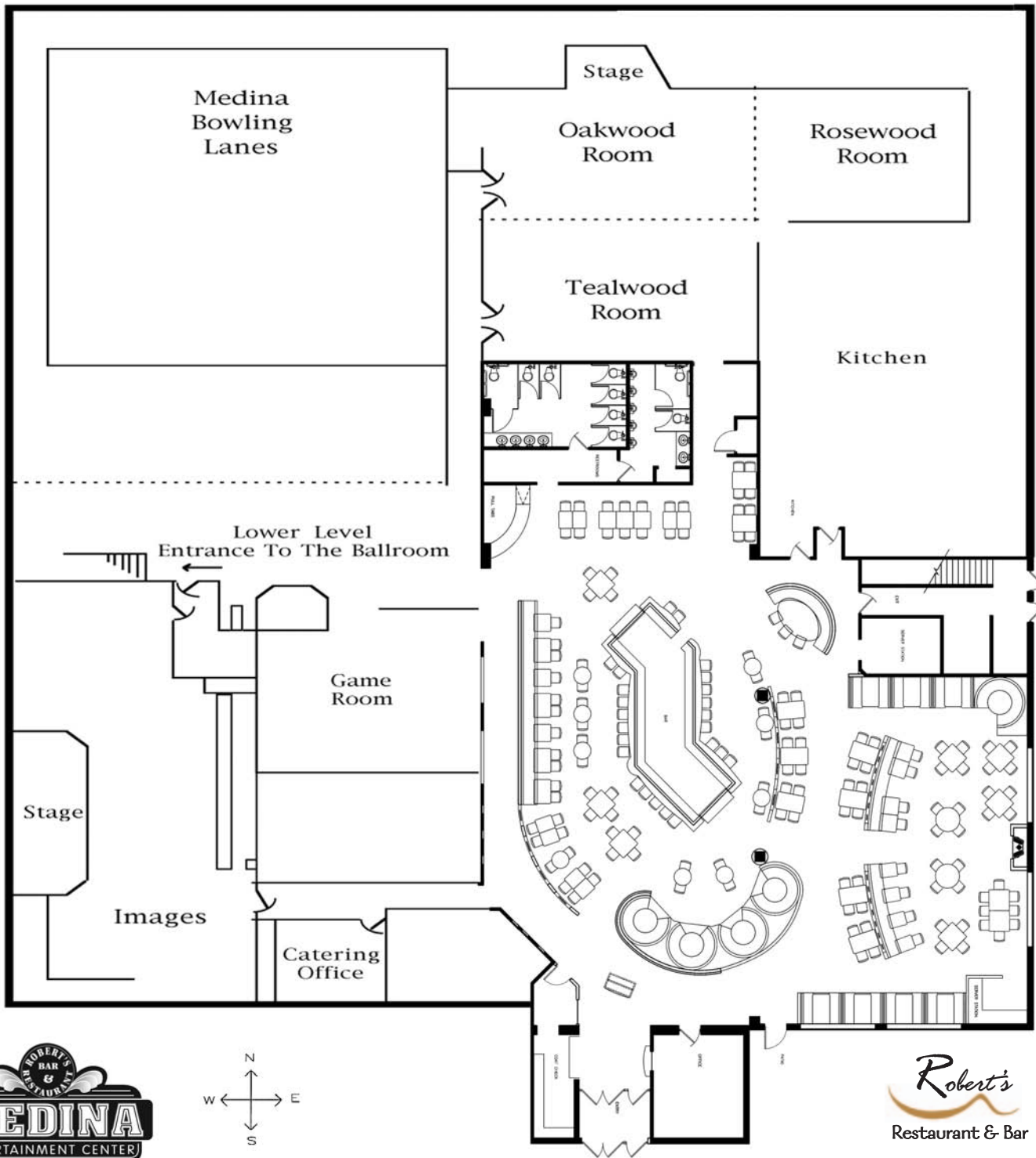

| Room | Size | Square Ft. | Banquets | | Social | | | U-Shape | Hollow Square | Dance Floor | Stage |
|------------------------|-----------|------------|-----------|-------------|-----------|---------|-----------|---------|---------------|-------------|-----------|
| | | | 5' Rounds | Rectangular | Reception | Theatre | Classroom | | | | |
| First Floor | | | | | | | | | | | |
| Images | 47' x 58' | 2726' | 120 | 170 | 280 | 200 | 75 | 30 | 32 | 14' x 19'8" | 14' x 11' |
| (three rooms together) | | | | | | | | | | | |
| Party Rooms | L- Shaped | 3570' | 224 | 250 | 350 | 300 | 108 | n/a | n/a | 22' x 45' | 14' x 8' |
| Tealwood | 30' x 40' | 1200' | 72 | 96 | 100 | 100 | 40 | 25 | 32 | | |
| Oakwood | 30' x 45' | 1350' | 72 | 96 | 100 | 100 | 40 | 25 | 32 | 22' x 45' | 14' x 8' |
| Rosewood | 30' x 34' | 1020' | 72 | 96 | 100 | 100 | 40 | 25 | 32 | | |

MEDINA ENTERTAINMENT CENTER • 500 Highway 55 • Medina, MN 55340 • (763) 478-6661
 The MEDINA INN • 400 Highway 55 • Medina, MN 55340 • (763) 478-9770 • 1 (800) 643-9211

Ballroom Floor Plan

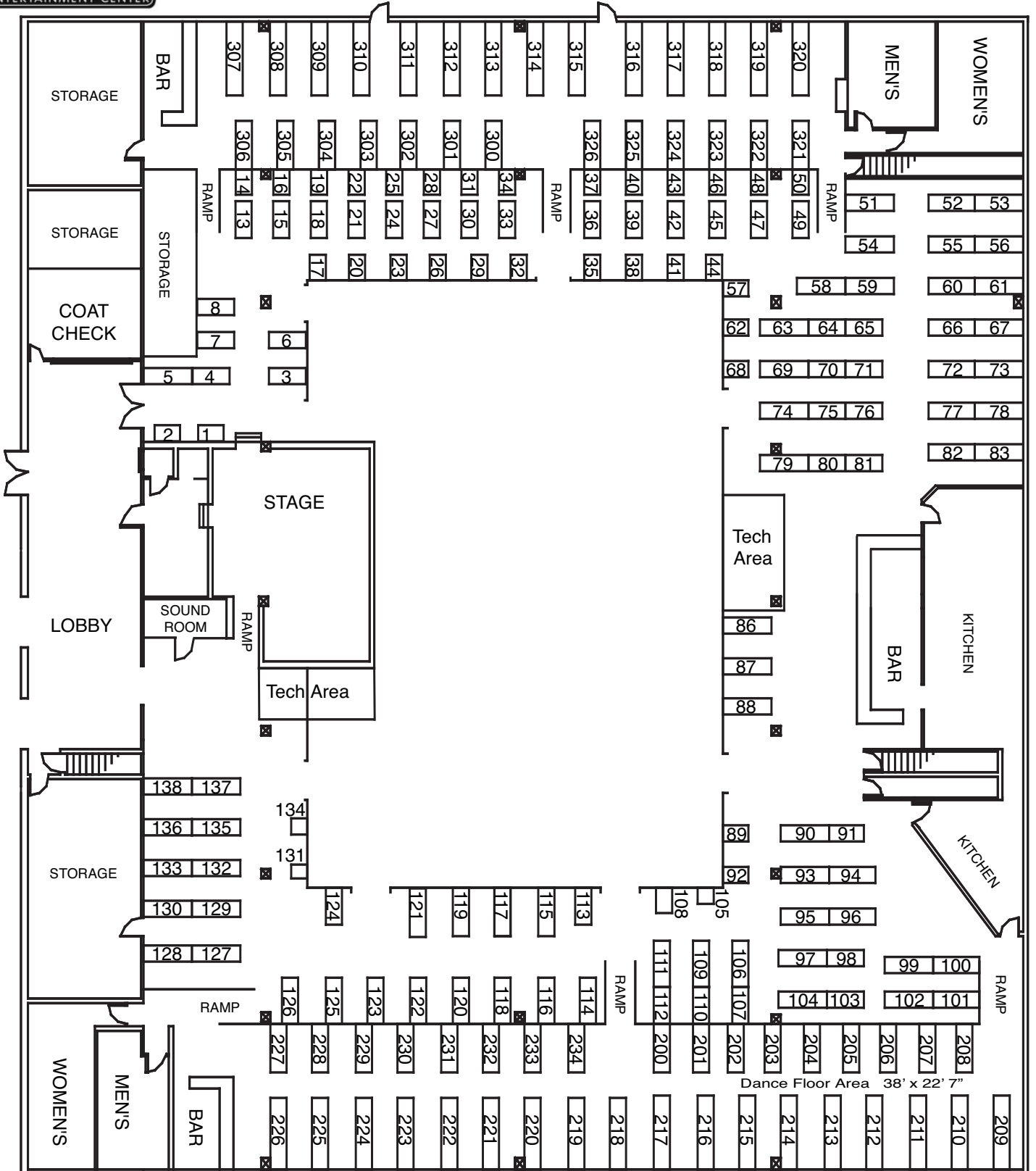
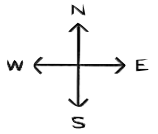

| Second Floor | Display area | 5' Rounds | Rectangular | Social Reception | Theatre | Classroom | 10'x10' Exhibitions | 8' x10' Exhibitions | Dance Floor | Stage | |
|--------------|--------------|----------------|-------------|------------------|---------|-----------|---------------------|---------------------|-------------|-----------|-----------|
| Ballroom | 180' x 160' | 22,000 sq. ft. | 300-1000 | 1200 | 2000 | 1600 | 600 | 80 | 90 | 65' x 95' | 33' x 25' |

MEDINA ENTERTAINMENT CENTER • 500 Highway 55 • Medina, MN 55340 • (763) 478-6661
 The MEDINA INN • 400 Highway 55 • Medina, MN 55340 • (763) 478-9770 • 1 (800) 643-9211



Ballroom Dimensions

Stage - 33' x 25'
Ballroom - 180' x 160'

Dance Floor - 65 x 95'
TOTAL SQ. FT. of Display Area - 22,000'

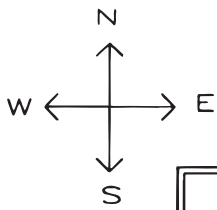

- Air Conditioned
- 220 Power Hook-up Outside
- 220 Power Hook-up Inside
- 11' Ceiling Height
- Electrical Outlets

- PA System Available
- Florescent Lighting for Displays
- Table & Chair Seating for 1600
- Handicap Accessibility
- Structural Supports

